



the Pioneer of Miniature CCD Cameras.

60 Dutch Hill Road, Suite 6, Orangeburg, New York 10962, U.S.A

Tel: +1-845-359-1490 / Fax: +1-845-359-1391

E-mail: sales@wateccameras.com

techsupport@wateccameras.com

<http://www.wateccameras.com>

1-888-567-4294

QRG.CAT.06.001



Watec CCD CAMERA GUIDE



**Security
Surveillance**

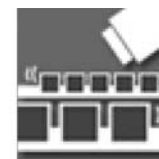

**Factory
Automation**



**Astronomical
Observation**



**Image
Processing**



**Law
Enforcement**



**Military
Operations**



WAT-35

[CHARACTERISTICS]

- 3.5 in TFT Monitor
- High Resolution
- 4 viewing modes
- Ultra thin, ultra light durable casing

[SPECIFICATIONS]

- Resolution: 480TVL
- Back light compensation - manually adjustable
- Contrast - manually adjustable
- Color - manually adjustable
- Mirror image and invert image adjustable
- Current: 180mA
- Dimensions: 100mm x 90 x 36.5 (WxHxD)
- Weight: 168g
- Power supply: DC+12V +/- 10%



Monitor

This Product will be Available Soon.

(for more information call 1-888-567-4294)



Respecting and creating harmony
between human beings and society.

Improving technologies.

ORIGIN OF COMPANY NAME

Watec is a compound word made up from Japanese and English. "Wa" is derived from the Kanji "和" implying harmony. "Tec" is an abbreviation of the English word "Technology". Watec signifies the creation of a company by a group of engineers seeking to create technology in harmony with humanity. The red "V" portion of the logo "W", comes from "Victory" in English which is entrusted and implied in the trademark "Watec".



WAT-300DH3

[CHARACTERISTICS]

- Single video / power transmission cable
- Built-in auto iris lens

[SPECIFICATIONS]

- Effective pixels: 380k(E), 440k(C)
- Resolution: 570TVL
- Minimum illumination: 0.04 lx. F2.0
- Gain control: AGC(5-32dB)
- S/N ratio: 50dB
- Shutter speed: 1/60(E) or 1/50(C)
- Built-in lens: Standard = f3.8 F2.0, Optional f2.9 F2.0
- Weight: 200g
- Power supply: DC+12V



WATER-RESISTANT MONOCHROME CAMERA

1/3" DSP

[ACCESSORIES] (included)

- AD-901(Power supply)
- WAT-300RXS(Receiver)
- Anchor plate
- Screws

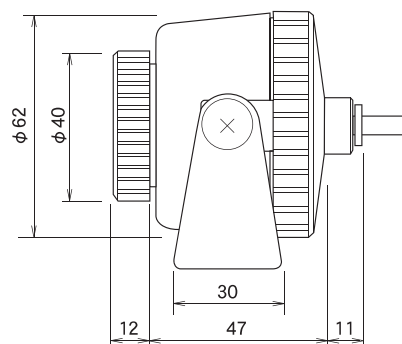
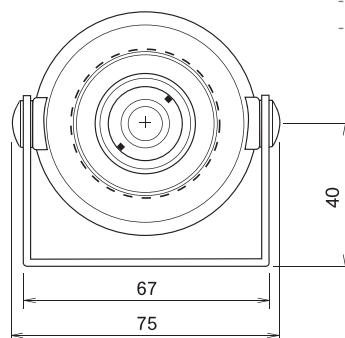

TABLE OF CONTENTS

Genwac / Watec	1
Company History	2
Service / WQS-Watec Quality-Control System	3
3-Year Warranty System / Our Warranty/ Repair Service	4
Pictures (Headquarters, Factory)	5,6
Technical Info	7

OUR CAMERAS

24-HOUR CAMERA	
WAT-232 [24-Hour-Eye] (1/3") NEW	9

COLOR CAMERAS	
WAT-221S (1/2"), WAT-231S (1/3")	10
WAT-250D (1/3")	11
WAT-230 VIVID (1/4") NEW	12
WAT-240 VIVID (1/4") NEW	13
W-01CDB3 (1/3") NEW	14

MONOCHROME CAMERAS	
WAT-902H2 SUPREME (1/2") NEW	15
WAT-902H3 SUPREME (1/3") NEW	15
WAT-902H2 ULTIMATE (1/2") NEW	16
WAT-902H3 ULTIMATE (1/3") NEW	16
WAT-902HB2/HB2S (1/2"), WAT-902HB3/HB3S (1/3")	17
WAT-902DM2/DM2S (1/2"), WAT-902DM3/DM3S (1/3")	18
WAT-120N (1/2")	19
WAT-525EX (1/2"), WAT-535EX (1/3")	20
WAT-660D (1/4")	21

WATER-RESISTANT CAMERAS	
WAT-200D (1/3")	22
WAT-300DH3 (1/3")	23

CONTROLLERS/MONITORS/LENSES	
Active Visual Mate	24
Monitor	25
Miniature Lenses	26



WAT - 660D

[CHARACTERISTICS]

- Super miniature model
- Various lenses available



[SPECIFICATIONS]

- Effective pixels: 250k(N), 290k(P)
- Resolution: 380TVL
- Minimum illumination: 0.08lx. F2.0
- Gain control: AGC(HI:5-32dB)
- S/N ratio: 46dB
- Shutter speed: EI(1/60(N) or 1/50(P)-1/100,000)
- Available lenses: G3.8, P3.7(G1.9, G2.5, G6.0, G8.0, G12.0, G25.0, P3.2, P3.7C)
- Weight: 30g
- Power supply: DC+9V

MONOCHROME CAMERA

1/4" DSP

[ACCESSORIES]

- K-59(Cable)
 - 660CB
 - Miniature compact lenses (see page 26)
- (note: glass & pinhole lenses are not interchangeable)

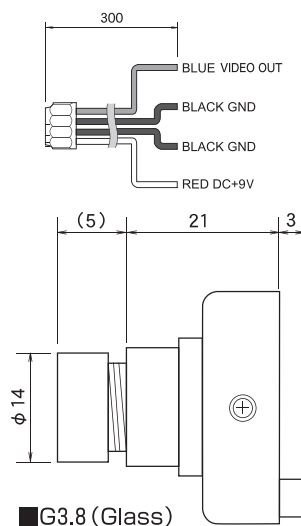
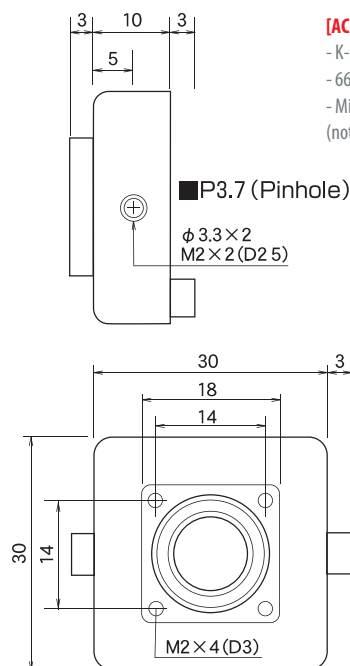

HISTORY

1987

Established in Tono, Kawasaki

1990

Yamagata factory was built in Higashine, Yamagata.

1994

Taiwan liaison office opened in Taipei, Taiwan

1995

The completion of Tsuruoka factory was celebrated.

Watec Taiwan liaison office incorporated.

1996

Head office moved to Tsuruoka from Kawasaki.

The 10th anniversary of the foundation of Watec Co., Ltd. memorial ceremony was held.

1999

The U.S. subsidiary, GENWAC, was founded in Orangeburg, NY.

2003

All subsidiaries become unified under the Watec nomenclature.

2004

Watec Co., Ltd. Beijing Liaison Office opened in Beijing, China.

2005

Watec/Genwac U.S. office.



WAT - 120N

[CHARACTERISTICS]

- Image storage system (Slow shutter speed)
- Super high sensitivity
- Hand-held remote controller
- High vertical resolution

[SPECIFICATIONS]

- Effective pixels: 380k(N), 440k(P)
- Resolution: 570TVL(H), 480TVL(V)
- Minimum illumination: 0.00002 lx. F1.4
- Gain control: MGC(8-38dB)
- S/N ratio: 52dB
- Shutter speeds(Frame): OFF, 1, 2, 4, 8, 16, 32, 64, 128, 256
- Gamma: $\gamma=0.35/0.45/1.0$
- Weight: 150g(Controller 210g)
- Power supply: DC+12V

[ACCESSORIES]

- WAT-120NRC(Controller)
- WPDC12(DC plug)
- AIC-G(Iris plug)
- 34CMA-R(C-mount adaptor)
- Hexagonal wrench



MONOCHROME CAMERA

1/2" DSP

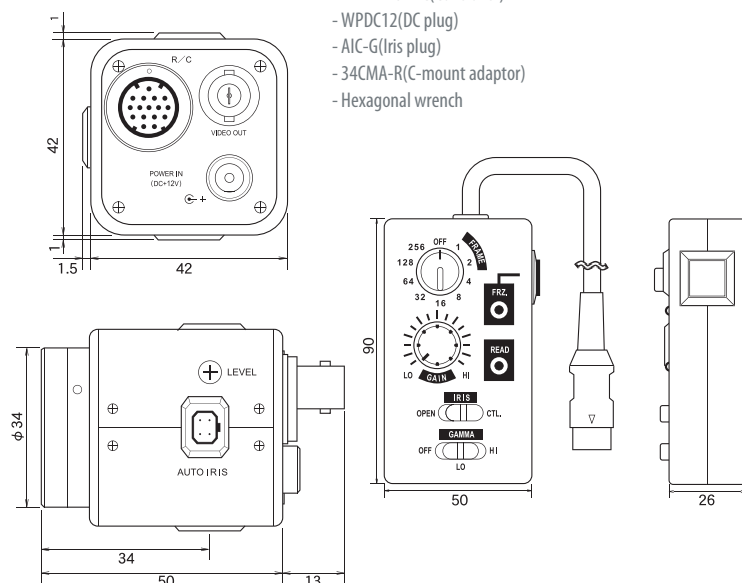

THREE-YEAR WARRANTY SYSTEM

All Watec products, before being shipped to our suppliers and our customers, are tested and inspected under severe inspection guidelines. This ensures that our products are not faulty, and are of the highest quality as directed by our Watec Quality-Control System.

OUR WARRANTY

Watec cameras have a 3-year warranty, and the peripherals have a 1-year warranty, provided that the products have been operated in accordance with our Operation Manual and have not been altered in any way. Watec offers a free repair services for goods that have malfunctioned under normal usage.

(NB: *The Watec 3-year warranty does not cover CCD repair or replacement caused by White blemish phenomina.*)

REPAIR SERVICE

Watec makes it a motto to repair Watec products first hand with the appropriate charge in accordance with the detailed defect information supplied by you.

All repairs in the Watec workshop are quickly and precisely dealt with and returned after the shortest repair period possible.



WAT - 902HB2/902HB2S WAT - 902HB3/902HB3S



MONOCHROME CAMERA

1/2" DSP - 902HB2 / 902HB2S
1/3" DSP - 902HB3 / 902HB3S

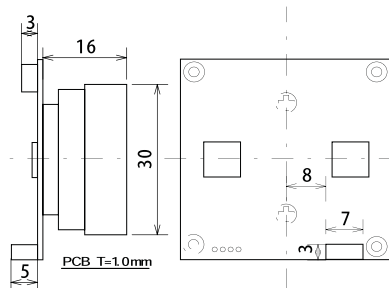
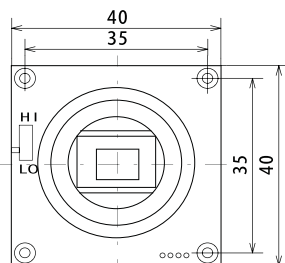
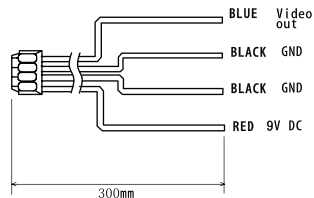

[CHARACTERISTICS]

- The 902HB series was developed in 2003 upon demand from the industries leading system integrators supplying product to the US Military, Undercover Law Enforcement Departments, Covert Operation groups and various Government agencies. Like the 902H, the HB series is sensitive to 0.0003 LUX @F1.4 and 570TV lines of resolution. At 40X40mm and approximately 23g the 902HB eliminates excess weight and space allowing for a lightweight portable product. Like the 902H the HB series ensures quality and reliability to those who demand it

[SPECIFICATIONS]

- Effective pixels: 380k(N), 440k(P)
- Resolution: 570TVL
- Minimum illumination: 0.0003 lx, F1.4(2/25), 0.0006 lx, F1.4(3/35)
- Gain control: AGC(HI:5-50dB, LO:5-32dB, Option: OFF=5db)
- Back light compensation: ON/OFF
- S/N ratio: 50dB (AGC OFF)
- Shutter speeds: EI(1/60(N) or 1/50(P)-1/100,000), FL, OFF
- Weight: 25g
- Power supply: DC+12V

[ACCESSORIES]

- K-59 (Cable & connector)
- Hexagonal wrench
- HB-CB
- Miniature compact lenses (see page 26)



OUR FACTORY





WAT-902H2 WAT-902H3 SUPREME



MONOCHROME CAMERA

1/2" DSP - 902H2
1/3" DSP - 902H3

[CHARACTERISTICS]

- Super High sensitivity (Near IR spectrum)
- BNC connector
- Video/DC iris auto-select
- Flickerless mode
- Compact & lightweight

[SPECIFICATIONS]

- Effective pixels: 380k(E), 440k(C)
- Resolution: 570TVL
- Minimum illumination: 0.000098 lx, F0.8(3)
- Gain control: AGC(HI:5-50dB, LO:5-32dB)
- Back light compensation: ON
- S/N ratio: 46dB
- Shutter speeds: EI(1/60(E) or 1/50(C)-1/100,000), FL, OFF
- Weight: 90g
- Power supply: DC+12V

[ACCESSORIES]

- Hexagonal wrench

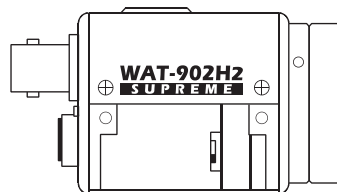
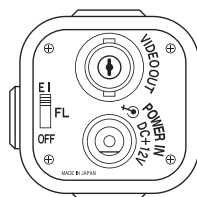
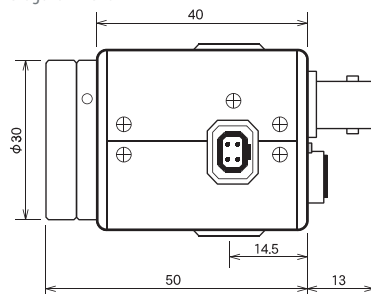
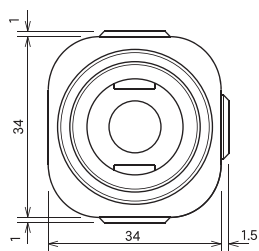

OUR CAMERAS



WAT-240 VIVID

[CHARACTERISTICS]

- Super miniature model
- High resolution
- Various lenses available
- Functional setting can be set as desired by using the ACTIVE VISUAL MATE, see pg. 24 (optional)

[SPECIFICATIONS]

- Effective pixels: 380k(N), 440k(P)
- Resolution: 450TVL
- Minimum illumination: 1.6 lx. F2.0
- Gain control: AGC(6-30dB)
- Back light compensation: ON
- S/N ratio: 50dB
- Shutter speed: EI(1/60(N) or 1/50(P))-1/100,000
- White balance: ATW
- Available lenses: G3.8(Glass), P3.7(Pin hole)
- Option lenses: G1.9, G2.5, G6.0, G8.0, G12.0, G25.0(Glass)
- Weight: 28g
- Power supply: DC+6V

[ACCESSORIES]

- Camera Holder
 - AVM control box
 - Miniature compact lenses (see page 26)
- (note: glass & pinhole lenses are not interchangeable)



COLOR

1/4" DSP

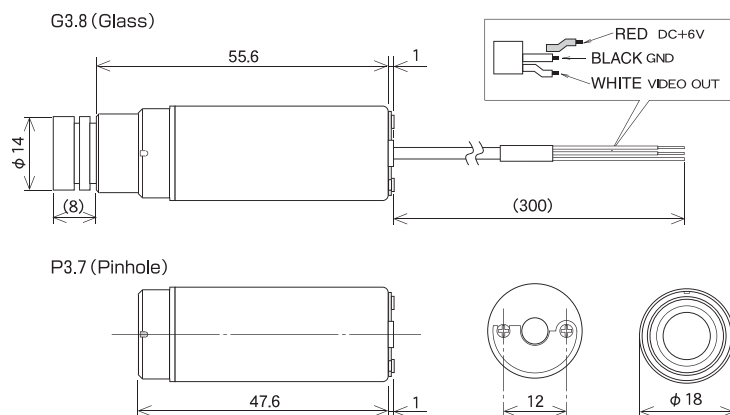

13



WAT-221S WAT-231S

[CHARACTERISTICS]

- Multi functions
- High sensitivity
- Simultaneous output of composite video & Y/C signals

[SPECIFICATIONS]

- Effective pixels: 380k(N), 440k(P)
- Resolution: 450TVL, 480TVL(Y/C)
- Minimum illumination: 0.1 lx. F1.2
- Gain control: AGC ON(HI:8-36dB, LO:8-24dB), OFF(8dB)
- Back light compensation: ON/OFF
- S/N ratio: 50dB
- Shutter speeds: EI(1/60(N) or 1/50(P))-1/100,000, EI(FL-1/100,000), FL, OFF, 1/250, 1/500, 1/1000, 1/2000, 1/4000, 1/10000
- White balance: ATW, PWB, MWB, 3200K, 4200K, 5100K, 6300K
- Weight: 160g
- Power supply: DC+12V

[ACCESSORIES]

- WPDC12(DC plug)
- AIC-G(Iris plug)
- Hexagonal wrench



COLOR

1/2" DSP 221S

1/3" DSP 231S

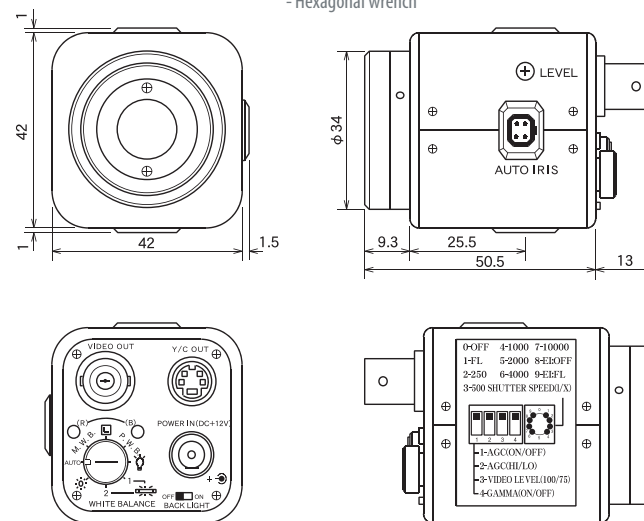

Watec

10



Dear Valued Customer,

On behalf of Watec Co., Ltd. Japan and Genwac, Incorporated, I would like to thank you for your recent purchase of a quality WATEC product. In doing so, you have joined an elite group most concerned with the absolute highest quality and most reliable products available on the market today. We dedicate our success and growth of our corporation to you, the customer.

For further information on our entire product line and to stay current with NEW product development, please visit us at www.wateccameras.com. Again, thank you and please do not hesitate to contact one of our sales persons with any technical questions or concerns regarding our products.

Most Sincerely,

Jason B. Williams
General Manager



MINIATURE LENSES

Type	OCD size	Focal length(mm) f/#-stop	Angle of view (H×V)	For:
1920BC-5 (G1.9)	Glass	f1.9 F2.0	115.2°×83.7°	WAT-230 VIVID/240 VIVID/230J/207A/240F/660D/704R/704RFA
2540BC-15 (G25.0)		f25.0 F4.0	8.2°×6.2°	
2520BC-5 (G2.5)		f2.5 F2.0	84°×62°	WAT-230 VIVID/240 VIVID/230J/207A/240F/660D/704R/704RFA/230CD/230CDB/230CDWB/660MD/660MDB/660MDWB
3820BC-5 (G3.8)		f3.8 F2.0	53°×40°	
0625BC-5 (G6.0)		f6.0 F2.5	34°×25°	WAT-230 VIVID/240 VIVID/230J/207A/240F/660D/704R/704RFA/230CD/230CDB/230CDWB/660MD/660MDB/660MDWB
0820BC-5 (G8.0)		f8.0 F2.0	25°×19°	
1220BC-5 (G12.0)	Pinhole	f12.0 F2.0	17°×13°	WAT-230 VIVID/240 VIVID/230J/207A/240F/660D/704R/704RFA
3745B-5 (P3.7)		f3.7 F4.5	54.2°×40.6°	
3245B-5 (P3.2)		f3.2 F4.5	66.9°×49.8°	WAT-660D/704R/704RFA
9802A-13 (P3.7C)		f3.7 F2.0	51°×40°	

NB: Miniature pinhole lenses cannot be interchanged with miniature glass lenses and vis-a-vis.



COMPACT LENSES

Type	OCD size	Focal length(mm) f/#-stop	Angle of view (H×V)	For:
3745B-22	Pinhole	1/2"	99°×73°	WAT-902H ₂ SUPREME/902H/902B/902DM ₂ /902DM _{2s}
		1/3"	72°×54°	
0814BC-22	Glass	1/2"	44°×33°	WAT-902H ₂ SUPREME/902DM ₂ /902DM _{2s} /502B
		1/3"	33°×25°	
0814BC-29		1/2"	44°×33°	WAT-250D/902H ₂ SUPREME/902DM ₂ /902DM _{2s} /502B
		1/3"	33°×25°	
1119BC-22	Glass	1/2"	30°×23°	WAT-902H ₂ SUPREME/902H/902B/902DM ₂ /902DM _{2s}
		1/3"	23°×17°	
1119BC-29		1/2"	30°×23°	WAT-221S/127LH/525EX
		1/3"	23°×17°	



CS Mounts are available - call for more information or see our website www.wateccameras.com





COMPANY PROFILE

Name: Watec Co., Ltd
Established: March 20, 1987
Representative: Shigemi Igarashi(President)

Watec Co., Ltd. (Head Office)

254-2 Nihonkoku, Daihoji, Tsuruoka-Shi, Yamagata-Ken, 997-0017, Japan
Tel: +81-235-23-4544 / Fax: +81-235-23-4409
E-mail: info-o@watec.co.jp
<http://www.watec.net>

Yamagata Factory

1518-3 Tatenokoshi, Kanisawa, Higashine-Shi, Yamagata-Ken, 997-3716, Japan
Tel: +81-237-43-6530 / Fax: +81-237-43-6531

Genwac/Watec (U.S. Office)

60 Dutch Hill Road, Suite 6, Orangeburg, New York 10962, U.S.A.
Tel: +1-845-359-1490 / Fax: +1-845-359-1391
1-888-567-4294
E-mail: sales@wateccameras.com
<http://www.wateccameras.com>



Active Visual Mate



Functional Setting Controller for the "VIVID" Models

1/4" DSP

[CHARACTERISTICS]

- Specifically designed for adjusting the VIVID MODEL functional settings conveniently.
- Compact & lightweight.
- Data settings can be saved and input to any other VIVID model.

[SPECIFICATIONS]

- Display: transfective STN LCD
- Display light: Yellow-green LED
- Max. #of characters per line: 20?~4 lines
- Power supply: DC+6V+/-10%(Use of power supply AD-603 or dry cell battery AA(x4)is recommended.)
- Battery life: ~8h(display light ON),~100h(display light OFF)
- Current: 50mA(display light ON)
- Weight: 330g

[ACCESSORIES]

- AD-603(Power supply)
- Cable(1m)

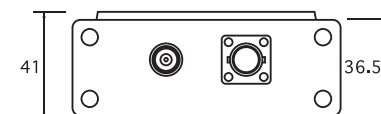
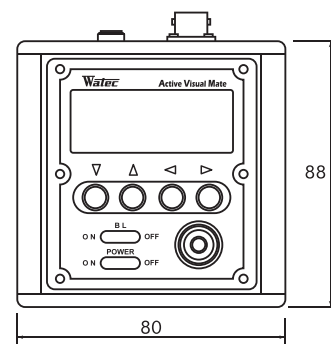



GENWAC/WATEC

We are proud to announce the official use of the Watec logo and WAT-prefixes under the Genwac name here in the United States. Genwac is a wholly owned division of Watec Co., Ltd. Japan and the only authorized importer of Watec Co., Ltd. Japan products in the U.S. and Canada. Improved distribution, enhanced product availability, and superior after sales support, make Watec cameras and accessories an even better value than ever. Same superior quality, same innovative technology; just another name to remember us by.

WATEC Co., Ltd. (Watec)

Watec is the proven leader in the design and manufacturing of innovative, miniature cameras for surveillance, law enforcement, image processing, medical applications, factory automation, astronomical observation and military, as well as use in Special Operation Divisions. Watec's quality and reliability allow us to stand as one of the few camera manufacturers to offer a **3-year warranty** on our full camera line, giving our clients the assurance of flawless, durable performance. We are honored to hold the reputation as the leading CCD camera manufacturer providing superior quality in miniature camera technology.

GLOBAL SALES - Direct subsidiaries of Watec Co., Ltd.



WAT-200D

[CHARACTERISTICS]

- Water-resistant
- Single video/power transmission cable
- Built-in AI with varifocal zoom lens
- External focus/zoom adjustment rings



[SPECIFICATIONS]

- Effective pixels: 380k(N), 440k(P)
- Resolution: 450TVL
- Minimum illumination: 1.0 lx. F1.6
- Gain control: AGC(8-36dB)
- S/N ratio: 50dB
- Shutter speed: 1/60(N) or 1/50(P)
- White balance: ATW
- Built-in lens: f4.0? 9.0 F1.6 auto iris lens with varifocal zoom
- Weight: 460g
- Power supply: DC+15V

[ACCESSORIES] (included)

- WAT-204RX(Receiver)
- AD-156(Power supply)

WATER-RESISTANT COLOR CAMERA

1/3" DSP

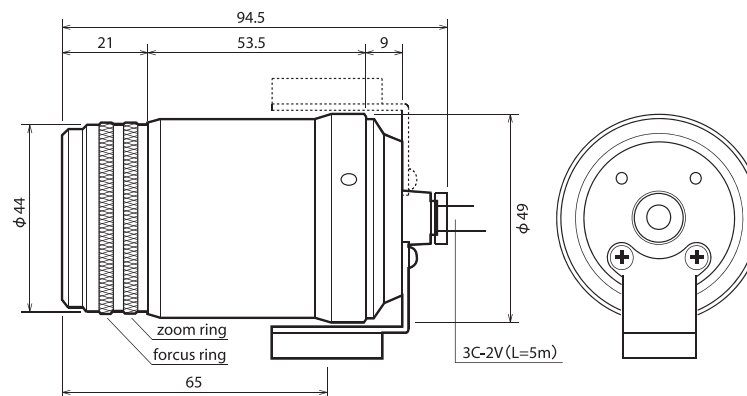
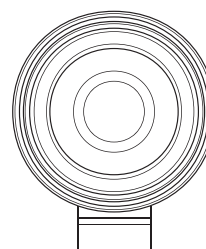



SERVICE

Watec offers a speedy service and technical support system throughout our distribution network. We have our own sales offices in Taiwan as well as in New York (U.S.A.). Simultaneously we make it a sales policy to nurture mutual prosperity with our customers, creating a good business partnership and encouraging consultation by way of routine correspondence. In addition, we are seeking to accommodate products customized according to the requirements of our customers in a wide range of applications.

WQS-WATEC QUALITY-CONTROL SYSTEM

Watec has established and is now fulfilling its own standard of quality control, WQS (Watec Quality-control System) in order to maintain a higher quality and more reliable Watec product. Watec products are handled using our piece by piece assembly process in addition to efficient management, from the time of receiving materials and parts to the shipment of products from our factory premises.

Watec products are assembled in a clean room and must pass quality inspections including a long-period aging test, in addition to the strict inspection guidelines for each production process. Only after these inspections, a camera is then acknowledged as a Watec product for our customers.



WAT - 525EX WAT - 535EX

[CHARACTERISTICS]

- Internal sync. / external sync.(C. video, C. sync.)
- Manual gain control

[SPECIFICATIONS]

- Effective pixels: 380k(N), 440k(P)
- Resolution: 570TVL
- Minimum illumination: 0.003 lx. F1.4
- Gain control: AGC(HI:5-32dB, LO:5-20dB), MGC(5-32dB)
- Back light compensation: ON(AGC/EI), OFF
- S/N ratio: 50dB
- Shutter speeds: EI(1/60(N) or 1/50(P)-1/100,000), FL, OFF, 1/250, 1/500, 1/1000, 1/2000, 1/5000, 1/10000, 1/100,000
- Weight: 130g
- Power supply: DC+12V

[ACCESSORIES]

- WPDC12(DC plug)
- AIC-G(Iris plug)
- Hexagonal wrench



MONOCHROME CAMERAS

1/2" DSP - 525EX
1/3" DSP - 535EX

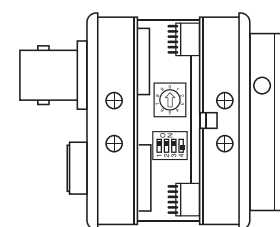
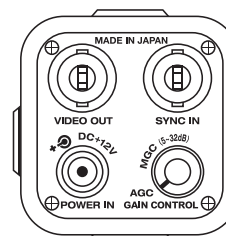
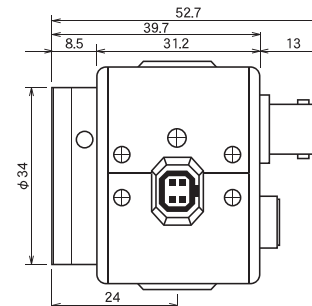
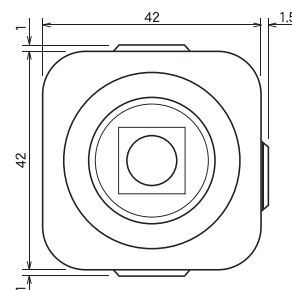



HEADQUARTERS (Tsuruoka)



YAMAGATA FACTORY (Higashine)



WAT - 902DM2/902DM2S WAT - 902DM3/902DM3S **SUPREME**



MONOCHROME CAMERA

1/2" DSP - 902DM2 / 902DM2S
1/3" DSP - 902DM3 / 902DM3S

[CHARACTERISTICS]

- Super high sensitivity
- Near IR spectrum (25,3S)
- DSP
- Inverted mirror image function

[SPECIFICATIONS]

- Effective pixels: 380k(N), 440k(P)
- Resolution: 570TVL
- Minimum illumination: 0.0006 lx. F1.4(2S), 0.0018 lx. F1.4(2), 0.0012 lx. F1.4(3S), 0.002 lx. F1.4(3)
- Gain control: AGC(HI:8-40dB, LO:8-22dB)
- Back light compensation: ON/OFF
- S/N ratio: 52dB
- Shutter speeds: E(1/60(N) or 1/50(P))-1/100,000, FL, OFF
- Weight: 90g
- Power supply: DC+12V

[ACCESSORIES]

- WPDC12(DC plug)
- AIC-G(Iris plug)
- Hexagonal wrench

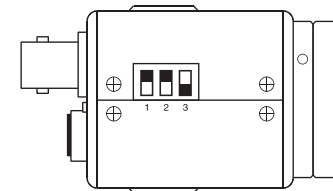
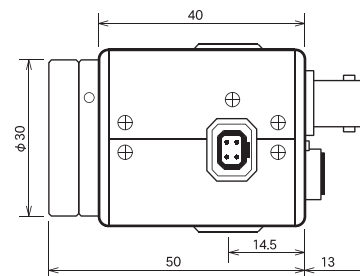
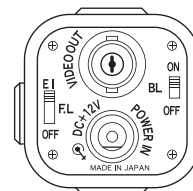
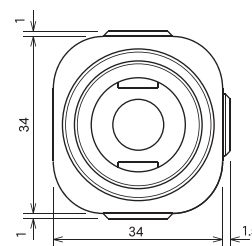



MANUFACTURING PROCESS FLOW CHART

(applies to all modified camera requests)

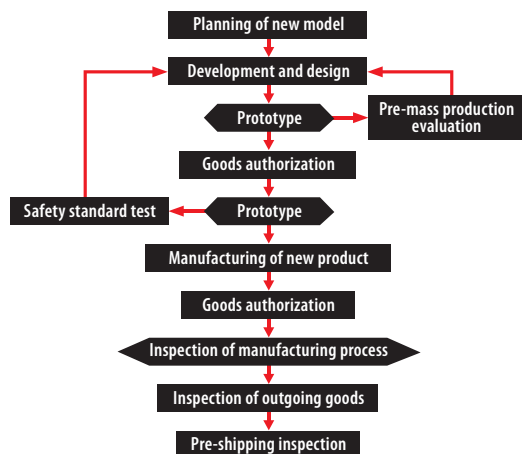

QUICK TECH SPECS

Pin Configuration Guide for Auto Iris Connectors

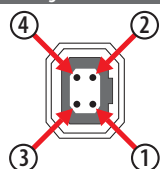

Pin#	EIAJ Video auto iris lens arrangement	EIAJ DC auto iris lens arrangement	Former Watec auto iris lens arrangement
①	Power	Control -	Power
②	Not used	Control +	Iris signals
③	Not used	Drive +	GND
④	GND	Drive -	GND
for	WAT-232/221S/231S/250D/120N/902H2&H3 Supreme/ 902H2&H3 Ultimate/902DM2/902DM5/902DM3/ 902DM3S/525EX/535EX/127LH/137LH		
	WAT-202D/202B/204CX/ 100N/902H/902B/502B		

DETERMINING LIGHT POWER

Bright sky	10,000 lx.
Cloudy sky (noon)	1,000 lx.
Office (with sunlight)	500 lx.
Office (without sunlight)	100 lx.
Parking lot (at night with lighting)	10 lx.
Twilight	1 lx.
Moonlight (full moon)	0.1 lx.
Moonlight (half moon)	0.001 lx.



WAT-902H2 (EIA & CCIR) WAT-902H3 (EIA & CCIR) ULTIMATE



[SPECIFICATIONS]

- Effective pixels: 380k(E), 440k(C)
- Resolution: 570TVL
- Minimum illumination: 0.0001 lx. F1.4(2), TBD(3)
- Gain control: MGC/AGC (LO) / AGC (HI) selectable
MGC: 5db-60db, AGC(HI:5-60dB, LO:5-32dB)
- Back light compensation: 4 kinds of BLC selectable
OFF(Whole Area), Mid, Lower, Mid + Lower
- S/N ratio: No less than 50dB (Gamma OFF, Gain min.)
- Shutter speeds: 11 Selectable speeds -
OFF (EIA: 1/60(S) CCIR: 1/50(S), FL (EIA: 1/100(S) CCIR: 1/120S
1/250(S)-1/100,000(S), E1 (OFF~1/100000(S)),
E12 (FL-1/100000(S))
- Weight: TBD
- Power supply: DC+12V

MONOCHROME CAMERA

[ACCESSORIES]

- Hexagonal wrench

1/2" DSP - 902H2
1/3" DSP - 902H3

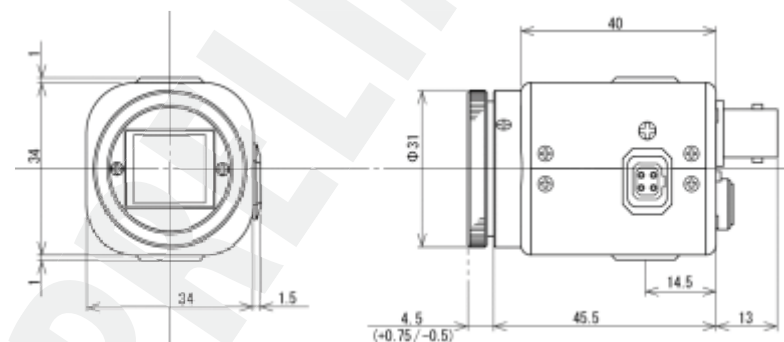



WAT-232 (24-Hour Eye)

[CHARACTERISTICS]

- Near IR monochrome for night & color for day
- Simultaneous output of composite video & Y/C signals
- Color/Monochrome version (auto/manual selection)

[SPECIFICATIONS]

- Effective pixels: 380k(N), 440k(P)
- Resolution: 450TVL, 480TVL(Y/C)
- Minimum illumination: 0.1 lx. F1.2(Color), 0.006 lx. F1.2(Monochrome)
- Gain control: AGC(8-36dB)
- Back light compensation: ON/OFF
- S/N ratio: 50dB
- Shutter speeds: EI(1/60(N) or 1/50(P)-1/100,000), FL, OFF
- White balance: ATW, PWB
- Weight: 150g
- Power supply: DC+12V

[ACCESSORIES]

- WPDC12(DC plug)
- AIC-G(Iris plug)
- Hexagonal wrench



24-HOUR

1/3" DSP

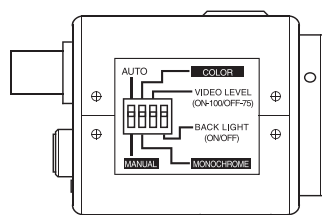
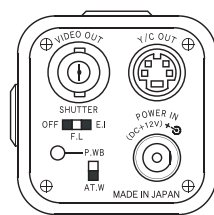
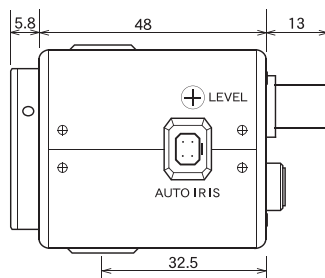
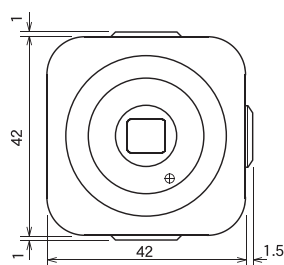

9



W-01CDB3

[SPECIFICATIONS]

- Effective pixels: 380k(E), 440k(C)
- Resolution: 450TVL
- Minimum illumination: 2.0 lx. F1.2
- Gain control: 6-30dB
- Back light compensation: ON (stress on the middle parts)
- S/N ratio: 50dB
- Shutter speeds: NTSC(E.I: 1/60-1/100,000), PAL(E.I: 1/50-1/100,000)
EI shutter(EIA: 1/60(CCIR=1/50), 1/100(CCIR=1/120), 1/250, 1/500, 1/1000, 1/2000, 1/5000, 1/10,000, 1/20,000, 1/50,000)
- Weight: 100g
- Power supply: DC+12V

[ACCESSORIES]

- AIC adapter cable
- HB-CB



COLOR CAMERA BOARD

1/3" DSP

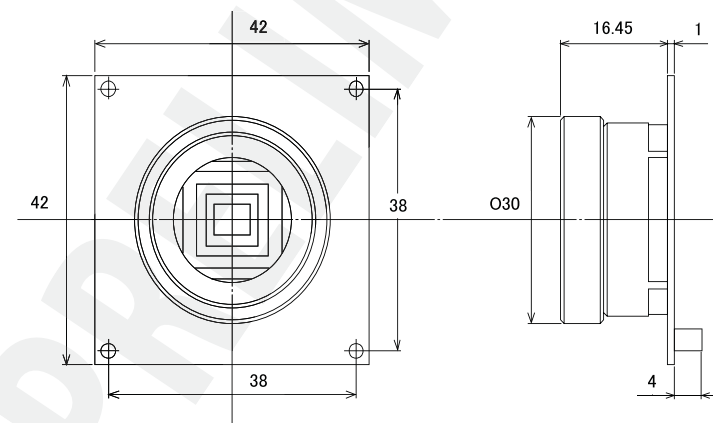

Watec

14



WAT-250D

[CHARACTERISTICS]

- Compact & lightweight
- High sensitivity

[SPECIFICATIONS]

- Effective pixels: 380k(N), 440k(P)
- Resolution: 450TV
- Minimum illumination: 0.1 lx. F1.2 L
- Gain control: AGC ON(HI: 8-36dB), OFF(8dB)
- Back light compensation: ON/OFF
- S/N ratio: 50dB
- Shutter speed: EI(1/60(N) or 1/50(P)-1/100,000), FL, OFF, 1/250, 1/500, 1/1000, 1/2000, 1/4000, 1/10000
- White balance: ATW, PWB
- Weight: 90g
- Power supply: DC+12V

[ACCESSORIES]

- WPDC12(DC plug)
- AIC-G(Iris plug)
- Hexagonal wrench



COLOR

1/3" DSP

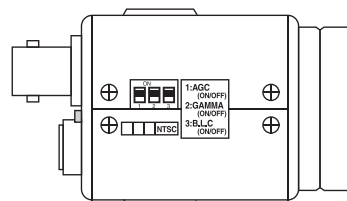
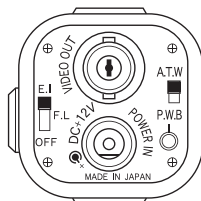
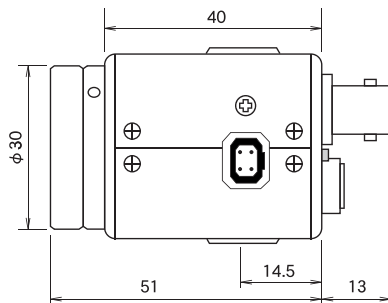
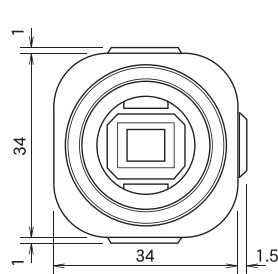

11



WAT-230 VIVID

[CHARACTERISTICS]

- Super miniature model
- High resolution
- Various lenses available
- Functional setting can be set as desired by using the ACTIVE VISUAL MATE, see pg. 24 (optional)

[SPECIFICATIONS]

- Effective pixels: 380k(N), 440k(P)
- Resolution: 450TVL
- Minimum illumination: 1.6 lx. F2.0
- Gain control: AGC(6-30dB)
- Back light compensation: ON
- S/N ratio: 50dB
- Shutter speed: EI(1/60(N) or 1/50(P)-1/100,000)
- White balance: ATW
- Available lenses: G3.8(Glass), P3.7(Pin hole)
- Option lenses: G1.9, G2.5, G6.0, G8.0, G12.0, G25.0(Glass)
- Weight: 35g
- Power supply: DC+6V

[ACCESSORIES]

- K-84(cable)
 - AVM control box
 - 230CB
 - Miniature compact lenses (see page 26)
- (note: glass & pinhole lenses are not interchangeable)



COLOR

1/4" DSP

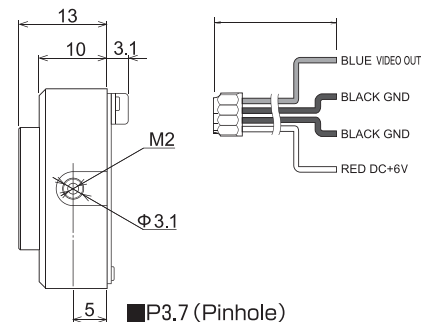
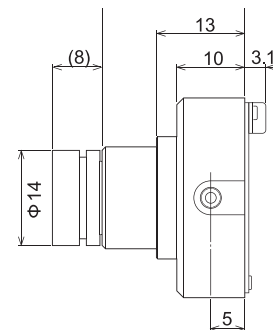
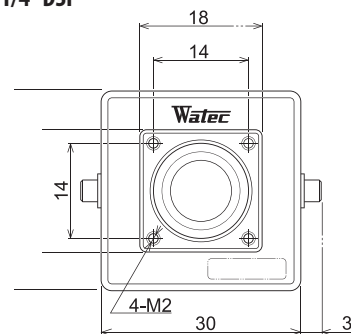

■ G3.8 (Glass)

■ P3.7 (Pinhole)

Water

12